

County K Crossroad (Racine County) Reconstruction

The Wisconsin Department of Transportation (WisDOT) will continue the reconstruction of County K, with work activities anticipated to resume in mid-March. The project is scheduled to be complete in early summer.

All closures are weather dependent and subject to change.

Long-term closure scheduled to begin early morning on Monday, March 19:

- East Frontage Road from County K south to Michel Court is scheduled to close long-term to traffic to reconstruct the roadway, and will remain closed through late May.

Alternate Route: Motorists are encouraged to use County K, County C, and the West Frontage Road to get around the closure. (See map for details.)

The project team thanks you for your patience and cooperation throughout this project!

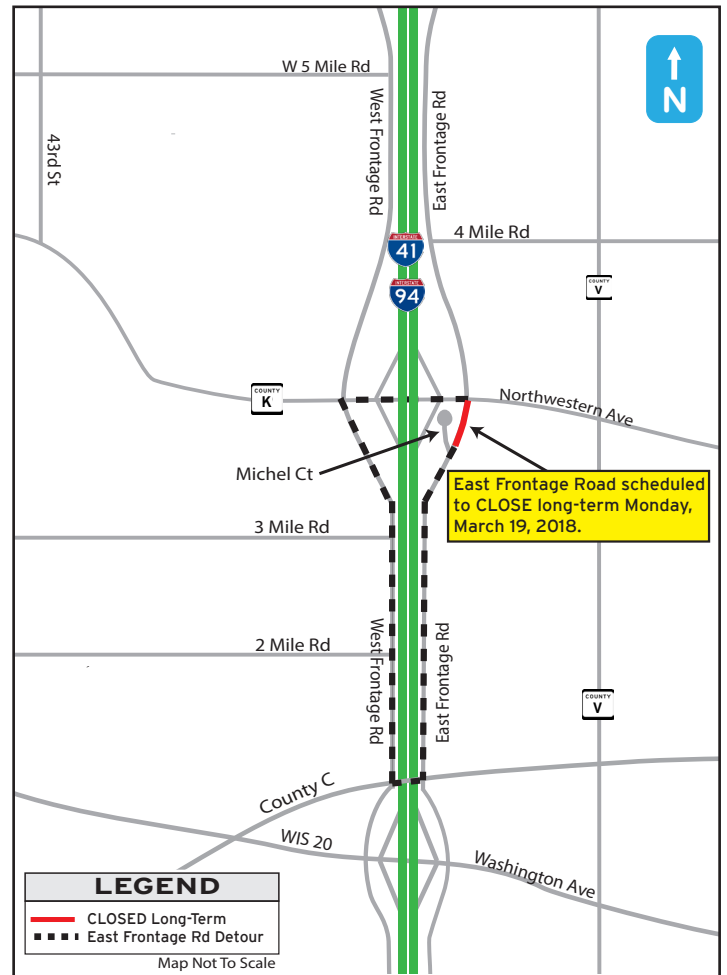

For general project information or to receive project updates, contact:

County K Crossroad Public Involvement Lead: Cynthia De Vor
Cell: (262) 510-8901
Cynthia@devorpr.com



Find us online at:
Plan94.org



Find us on Facebook at:
Wisconsin Plan 94



Find us on Twitter at:
@WisconsinPlan94



Plan Ahead, Drive Safely, Move Forward